

PALMERSTON STREET, STOCKTON-ON-TEES, TS18 1NU



- ▲ One Bedroom First Floor Flat
- ▲ Perfect Retirement Pad or Rental Investment
- ▲ Entrance Porch
- ▲ Living Room

- ▲ Breakfast Kitchen
- ▲ Bedroom
- ▲ Box/Storeroom
- ▲ Bathroom

Offers Over £50,000

www.michaelpoole.co.uk

Michael Poole
sales | lettings | auctions



This one bedroom first floor flat will make the perfect retirement pad or rental investment.

The accommodation comprises of entrance porch, living room, breakfast kitchen, bedroom, box/storeroom, and bathroom.

- Mains Utilities
- Gas Central Heating
- Mains Sewerage
- No Known Flooding Risk
- No Known Legal Obligations
- Standard Broadband & Mobile Signal
- Rights of Way on Stairs, Gardens & Walkways

ACCOMMODATION

ENTRANCE PORCH - Double glazed entrance door to entrance porch with inner door to the living room.

LIVING ROOM - 3.78m x 3.43m (12'5" x 11'3")
With double glazed window to the front aspect and twin radiator.



TO VIEW: Tel: **01642 355000**
17 High Street, Stockton-on-Tees, Cleveland, TS18 1SP

www.michaelpoole.co.uk





KITCHEN DINER - 4.4m x 2.2m (14'5" x 7'3")

With double glazed window to the front aspect, single radiator, wall, drawer, and floor units with complementary granite effect worktops incorporating a stainless-steel sink and drainer unit, electric oven, plumbing for washing machine and tiled splashbacks.

BEDROOM - 3.68m x 2.51m (12'1" x 8'3")

With double glazed window to the rear aspect, single radiator, and loft access.

INNER HALL - With single radiator and linen cupboard.

STORAGE ROOM - 1.6m x 1.6m (5'3" x 5'3")

With single radiator, wall mounted combi boiler and double-glazed window to the rear aspect.

BATHROOM - With double glazed window to the rear aspect, side panelled bath, pedestal wash hand basin, low level WC, shower enclosure, tiled walls, and single radiator.

- Mains Utilities
- Gas Central Heating
- Mains Sewerage
- No Known Flooding Risk
- No Known Legal Obligations
- Standard Broadband & Mobile Signal
- Rights of Way on Stairs, Gardens & Walkways

AGENTS REF: - LJ/LS/STO240050/15032024



Council Tax Band: A **Tenure:** Leasehold

TO VIEW: Contact our Stockton office on
Tel: 01642 355000



TO VIEW: Tel: 01642 355000
17 High Street, Stockton-on-Tees, Cleveland, TS18 1SP

www.michaelpoole.co.uk





TO VIEW: Tel: 01642 355000
17 High Street, Stockton-on-Tees, Cleveland, TS18 1SP

www.michaelpoole.co.uk

Michael Poole
sales | lettings | auctions

GROUND FLOOR

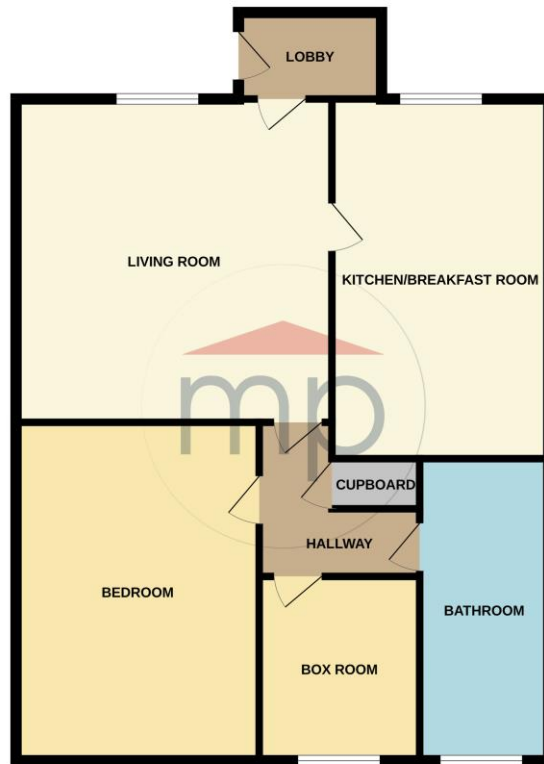

Whilst every attempt has been made to ensure the accuracy of the floorplan contained here, measurements of doors, windows, rooms and any other items are approximate and no responsibility is taken for any error, omission or mis-statement. This plan is for illustrative purposes only and should be used as such by any prospective purchaser. The services, systems and appliances shown have not been tested and no guarantee as to their operability or efficiency can be given. Made with Metropix ©2024.

The information provided about this property does not constitute or form part of an offer or contract, nor may it be regarded as representations. All interested parties must verify accuracy and your solicitor must verify tenure and lease information, fixtures and fittings and, where the property has been recently constructed, extended or converted, that planning/building regulation consents are in place. All dimensions are approximate and quoted for guidance only, as are floor plans which are not to scale, and their accuracy cannot be confirmed. Reference to appliances and/or services does not imply that they are necessarily in working order or fit for the purpose. We offer our clients an optional conveyancing service, through panel conveyancing firms, via MWU and we receive on average a referral fee of one hundred and thirty pounds, only on completion of the sale. If you do use this service, the referral fee is included within the amount that you will be quoted by our suppliers. All quotes will also provide details of referral fees payable.

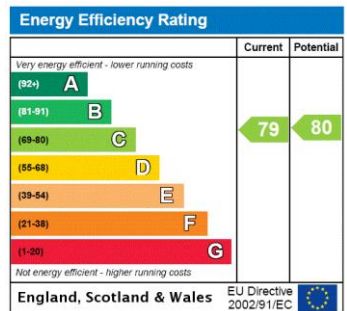

TO VIEW: Contact our Stockton Office on Tel: **01 642 355000**
17 High Street, Stockton-on-Tees, Cleveland, TS18 1SP